

Steel pressure plugs, high
Verschlußschrauben Stahl, groß



TAP

Giu 2023

TAPPI CONICI ACCIAIO ALTI

Materiale: 5.8 - RC 35/40

Material:

Werkstoff:

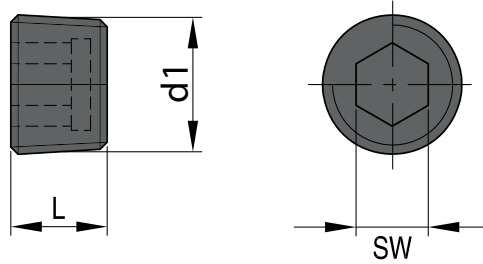

| Codice | d1 | L | SW |
|----------|--------|------|-------|
| TAP-R012 | 1/2" | 17,4 | 3/8" |
| TAP-R014 | 1/4" | 12,7 | 1/4" |
| TAP-R018 | 1/8" | 9,5 | 3/16" |
| TAP-R034 | 3/4" | 20,6 | 9/16" |
| TAP-R038 | 3/8" | 14,3 | 5/16" |
| TAP-R058 | 5/8" | 19 | 1/2" |
| TAP-R100 | 1" | 25,4 | 5/8" |
| TAP-R112 | 1" 1/2 | 31,7 | 3/4" |
| TAP-R134 | 1" 3/4 | 31,7 | 3/4" |

Esempio d'ordine: Codice

Order example:

Bestellbeispiel:

RAFFREDDAMENTI
Cooling items
Kühlmittelschlüsse