

TAPPO A VITE T941

Materiale: ottone nichelato + Cu
Material: nickel plated brass + Cu
Werkstoff: vernickeltem Messing + Cu

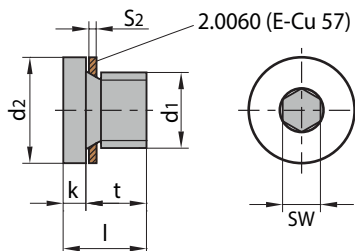

| Codice | d1 | d2 | l | SW | k | S2 | t |
|----------|---------|----|----|----|---|-----|----|
| T941-R12 | 1/2" | 26 | 18 | 10 | 4 | 1,5 | 14 |
| T941-R14 | 1/4" | 18 | 15 | 6 | 3 | 1,5 | 12 |
| T941-R18 | 1/8" | 14 | 11 | 5 | 3 | 1 | 8 |
| T941-R34 | 3/4" | 32 | 20 | 12 | 4 | 2 | 16 |
| T941-R38 | 3/8" | 22 | 15 | 8 | 3 | 1,5 | 12 |
| T941-M07 | M7x1 | 11 | 11 | 3 | 3 | 1 | 8 |
| T941-M09 | M9x1 | 13 | 11 | 5 | 3 | 1 | 8 |
| T941-M10 | M10x1 | 14 | 11 | 5 | 3 | 1 | 8 |
| T941-M11 | M11x1 | 15 | 11 | 5 | 3 | 1 | 8 |
| T941-M12 | M12x1,5 | 17 | 15 | 6 | 3 | 1,5 | 12 |
| T941-M14 | M14x1,5 | 19 | 15 | 6 | 3 | 1,5 | 12 |

Esempio d'ordine: Codice

Order example:

Bestellbeispiel: